



Redmayne Arnold & Harris
estate agents, letting agents & surveyors

rah.co.uk



TO LET



33 Narrow Lane, Histon, Cambridge, CB24 9HD

£1,650 PCM



THE PROPERTY

A spacious three-bedroom property in the popular village of Histon. The village boasts many local facilities including excellent schooling for all ages from pre-school to sixth form, including the well regarded Impington Village College. Good local shopping is available in the village and there is a regular bus service to Cambridge.

Its convenient location is just 3 miles from Cambridge city centre, with the A14 and M11 being within a few minutes drive from the property. Histon is served by Cambridgeshire County Council's Guided Busway with an estimated journey time to the Science Park of approximately 3 minutes and is a 10 minute cycle. It is also conveniently located for Cambridge North railway station.

Downstairs, the property comprises of an entrance hall, w.c, kitchen, and open plan lounge/diner. Upstairs, there are three good sized bedrooms and a family bathroom. The property is set back from the road in a quiet location, with a driveway for 2 cars and a garage. To the rear is a fully enclosed large garden. This property is managed by the Landlord.

- Council Tax Band C
- EPC Band C
- Minimum 6-month tenancy
- Deposit £1900
- Holding Deposit: £390

SITUATION

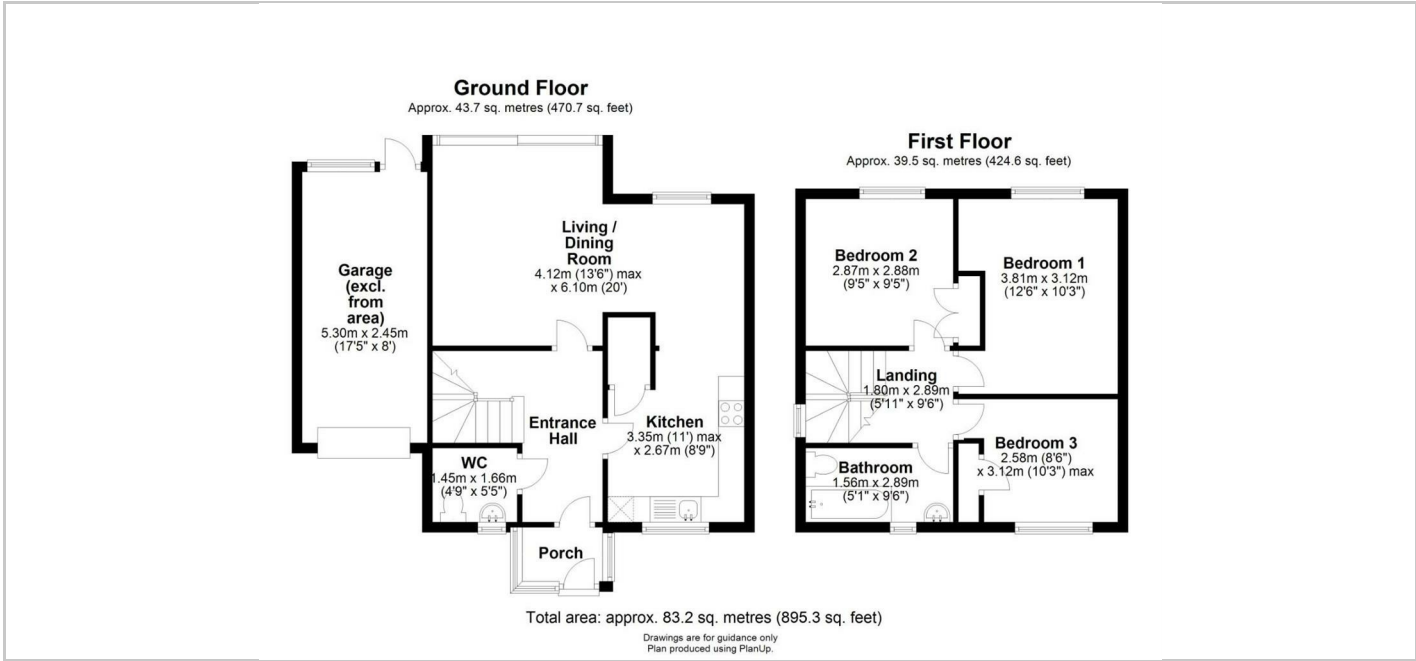

Directions

